

CPC-MR7 - Miniature Linear Guides

DIMENSIONS

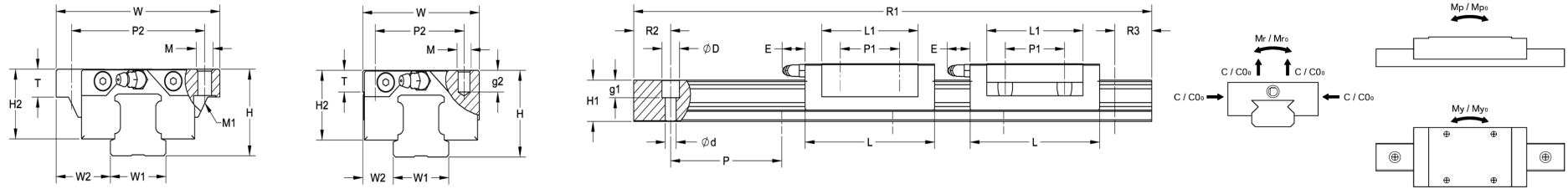

SPECIFICATIONS

Part Number	Fabrication Dimensions (mm)		Block Dimensions (mm)											Rail Dimensions (mm)					Load Capacities (KN)		Static Moment (Nm)			Block Weight (lbs)	Rail Weight (lbs)
	H	W ₂	W	L	L ₁	h ₂	P	P ₁	P ₂	D x d x g ₁	M x g ₂	S	T	W ₁	H ₁	R ₁	R ₂	R ₃	C	C ₀	M _{r0}	M _{p0}	M _{y0}		
CPC-MR7MLSSV0N-100-5-5	8	5	17	31.5	21.8	6.7	15	13	12	4.2 x 2.4 x 2.3	M2 x 2.5	1.6	2.8	7	4.7	100	5	5	1.31	2.44	9	7.7	7.7	0.03	0.05
CPC-MR7MLSSV0N-300-7.5-7.5	8	5	17	31.5	21.8	6.7	15	13	12	4.2 x 2.4 x 2.3	M2 x 2.5	1.6	2.8	7	4.7	300	7.5	7.5	1.31	2.44	9	7.7	7.7	0.03	0.14
CPC-MR7MLSSV0N-500-10-10	8	5	17	31.5	21.8	6.7	15	13	12	4.2 x 2.4 x 2.3	M2 x 2.5	1.6	2.8	7	4.7	500	10	10	1.31	2.44	9	7.7	7.7	0.03	0.24
CPC-MR7MLSSV0N-780-7.5-7.5	8	5	17	31.5	21.8	6.7	15	13	12	4.2 x 2.4 x 2.3	M2 x 2.5	1.6	2.8	7	4.7	780	7.5	7.5	1.31	2.44	9	7.7	7.7	0.03	0.37
CPC-MR7MLSSV0N-1000L	8	5	17	31.5	21.8	6.7	15	13	12	4.2 x 2.4 x 2.3	M2 x 2.5	1.6	2.8	7	4.7	1000	7.5	7.5	1.31	2.44	9	7.7	7.7	0.03	0.5
CPC-MR7MNSSV0N-100-5-5	8	5	17	24.1	14.3	6.6	15	8	12	4.2 x 2.4 x 2.3	M2 x 2.5	1.6	2.8	7	4.7	100	5	5	0.89	1.4	5.2	3.3	3.3	0.02	0.05
CPC-MR7MNSSV0N-300-7.5-7.5	8	5	17	24.1	14.3	6.6	15	8	12	4.2 x 2.4 x 2.3	M2 x 2.5	1.6	2.8	7	4.7	300	7.5	7.5	0.89	1.4	5.2	3.3	3.3	0.02	0.14
CPC-MR7MNSSV0N-500-10-10	8	5	17	24.1	14.3	6.6	15	8	12	4.2 x 2.4 x 2.3	M2 x 2.5	1.6	2.8	7	4.7	500	10	10	0.89	1.4	5.2	3.3	3.3	0.02	0.24
CPC-MR7MNSSV0N-780-7.5-7.5	8	5	17	24.1	14.3	6.6	15	8	12	4.2 x 2.4 x 2.3	M2 x 2.5	1.6	2.8	7	4.7	780	7.5	7.5	0.89	1.4	5.2	3.3	3.3	0.02	0.37
CPC-MR7MNSSV0N-1000L	8	5	17	24.1	14.3	6.6	15	8	12	4.2 x 2.4 x 2.3	M2 x 2.5	1.6	2.8	7	4.7	1000	7.5	7.5	0.89	1.4	5.2	3.3	3.3	0.02	0.5
CPC-MR7WLSSV0N-100-5-5	9	5.5	25	40.8	30.1	7.1	30	19	19	6 x 3.5 x 3.5	M3 x 3	1.9	3.2	14	5.2	100	5	5	1.57	3.14	22.65	14.9	14.9	0.06	0.11
CPC-MR7WLSSV0N-300-15-15	9	5.5	25	40.8	30.1	7.1	30	19	19	6 x 3.5 x 3.5	M3 x 3	1.9	3.2	14	5.2	300	15	15	1.57	3.14	22.65	14.9	14.9	0.06	0.34
CPC-MR7WLSSV0N-500-10-10	9	5.5	25	40.8	30.1	7.1	30	19	19	6 x 3.5 x 3.5	M3 x 3	1.9	3.2	14	5.2	500	10	10	1.57	3.14	22.65	14.9	14.9	0.06	0.57
CPC-MR7WLSSV0N-780-15-15	9	5.5	25	40.8	30.1	7.1	30	19	19	6 x 3.5 x 3.5	M3 x 3	1.9	3.2	14	5.2	780	15	15	1.57	3.14	22.65	14.9	14.9	0.06	0.89
CPC-MR7WLSSV0N-1000L	9	5.5	25	40.8	30.1	7.1	30	19	19	6 x 3.5 x 3.5	M3 x 3	1.9	3.2	14	5.2	1000	7.5	7.5	1.57	3.14	22.65	14.9	14.9	0.06	1.14
CPC-MR7WNSSV0N-040-5-5	9	5.5	25	31.9	21.2	7.1	30	10	19	6 x 3.5 x 3.5	M3 x 3	1.9	3.2	14	5.2	40	5	5	1.18	2.095	15	7.3	7.3	0.04	0.05
CPC-MR7WNSSV0N-100-5-5	9	5.5	25	31.9	21.2	7.1	30	10	19	6 x 3.5 x 3.5	M3 x 3	1.9	3.2	14	5.2	100	5	5	1.18	2.095	15	7.3	7.3	0.04	0.11
CPC-MR7WNSSV0N-300-15-15	9	5.5	25	31.9	21.2	7.1	30	10	19	6 x 3.5 x 3.5	M3 x 3	1.9	3.2	14	5.2	300	15	15	1.18	2.095	15	7.3	7.3	0.04	0.34
CPC-MR7WNSSV0N-500-10-10	9	5.5	25	31.9	21.2	7.1	30	10	19	6 x 3.5 x 3.5	M3 x 3	1.9	3.2	14	5.2	500	10	10	1.18	2.095	15	7.3	7.3	0.04	0.57
CPC-MR7WNSSV0N-780-15-15	9	5.5	25	31.9	21.2	7.1	30	10	19	6 x 3.5 x 3.5	M3 x 3	1.9	3.2	14	5.2	780	15	15	1.18	2.095	15	7.3	7.3	0.04	0.89
CPC-MR7WNSSV0N-1000L	9	5.5	25	31.9	21.2	7.1	30	10	19	6 x 3.5 x 3.5	M3 x 3	1.9	3.2	14	5.2	1000	7.5	7.5	1.18	2.095	15	7.3	7.3	0.04	1.14

The rated load capacities and static moment values are calculated according to the ISO14728 standard. The rated life for basic dynamic load is defined as the total 100km travel distance that 90% of a group of identical linear guides can be operated individually under the same conditions, free from any material damage caused by rolling fatigue-When the standard of 50km travel distance is applied. The basic dynamic load rating C of ISO14728 should be multiplied by 1.26 for conversion.

Distributed by Anaheim Automation, Inc.
 USA Stock in Anaheim, CA
 1-800-345-9401
www.anaheimautomation.com

CPC-MR7 - Miniature Linear Guides

DIMENSIONS

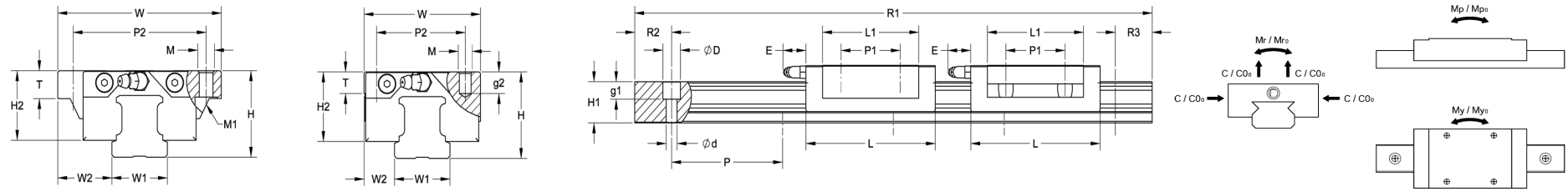

SPECIFICATIONS

Part Number	Fabrication Dimensions (mm)		Block Dimensions (mm)											Rail Dimensions (mm)					Load Capacities (kN)		Static Moment (Nm)			Block Weight (lbs)	Rail Weight (lbs)
	H	W ₂	W	L	L ₁	h ₂	P	P ₁	P ₂	D x d x g ₁	M x g ₂	S	T	W ₁	H ₁	R ₁	R ₂	R ₃	C	C ₀	Mr ₀	Mp ₀	My ₀		
CPC-MR7MLSUV0N-100-5-5	8	5	17	31.4	21.8	6.9	15	13	12	4.2 x 2.4 x 2.3	M2 x 2.5	1.6	2.8	7	4.7	100	5	5	1.31	2.44	9	7.7	7.7	0.03	0.05
CPC-MR7MLSUV0N-300-7.5-7.5	8	5	17	31.4	21.8	6.9	15	13	12	4.2 x 2.4 x 2.3	M2 x 2.5	1.6	2.8	7	4.7	300	7.5	7.5	1.31	2.44	9	7.7	7.7	0.03	0.14
CPC-MR7MLSUV0N-500-10-10	8	5	17	31.4	21.8	6.9	15	13	12	4.2 x 2.4 x 2.3	M2 x 2.5	1.6	2.8	7	4.7	500	10	10	1.31	2.44	9	7.7	7.7	0.03	0.24
CPC-MR7MLSUV0N-780-7.5-7.5	8	5	17	31.4	21.8	6.9	15	13	12	4.2 x 2.4 x 2.3	M2 x 2.5	1.6	2.8	7	4.7	780	7.5	7.5	1.31	2.44	9	7.7	7.7	0.03	0.37
CPC-MR7MLSUV0N-1000L	8	5	17	31.4	21.8	6.9	15	13	12	4.2 x 2.4 x 2.3	M2 x 2.5	1.6	2.8	7	4.7	1000	7.5	7.5	1.31	2.44	9	7.7	7.7	0.03	0.5
CPC-MR7MNSUV0N-100-5-5	8	5	17	24	14.3	7	15	8	12	4.2 x 2.4 x 2.3	M2 x 2.5	1.6	2.8	7	4.7	100	5	5	0.89	1.4	5.2	3.3	3.3	0.02	0.05
CPC-MR7MNSUV0N-300-7.5-7.5	8	5	17	24	14.3	7	15	8	12	4.2 x 2.4 x 2.3	M2 x 2.5	1.6	2.8	7	4.7	300	7.5	7.5	0.89	1.4	5.2	3.3	3.3	0.02	0.14
CPC-MR7MNSUV0N-500-10-10	8	5	17	24	14.3	7	15	8	12	4.2 x 2.4 x 2.3	M2 x 2.5	1.6	2.8	7	4.7	500	10	10	0.89	1.4	5.2	3.3	3.3	0.02	0.24
CPC-MR7MNSUV0N-780-7.5-7.5	8	5	17	24	14.3	7	15	8	12	4.2 x 2.4 x 2.3	M2 x 2.5	1.6	2.8	7	4.7	780	7.5	7.5	0.89	1.4	5.2	3.3	3.3	0.02	0.37
CPC-MR7MNSUV0N-1000L	8	5	17	24	14.3	7	15	8	12	4.2 x 2.4 x 2.3	M2 x 2.5	1.6	2.8	7	4.7	1000	7.5	7.5	0.89	1.4	5.2	3.3	3.3	0.02	0.5
CPC-MR7WLSUV0N-100-5-5	9	5.5	25	40.9	30.1	7.4	30	19	19	6 x 3.5 x 3.5	M3 x 3	1.9	3.2	14	5.2	100	5	5	1.57	3.14	22.65	14.9	14.9	0.06	0.11
CPC-MR7WLSUV0N-300-15-15	9	5.5	25	40.9	30.1	7.4	30	19	19	6 x 3.5 x 3.5	M3 x 3	1.9	3.2	14	5.2	300	15	15	1.57	3.14	22.65	14.9	14.9	0.06	0.34
CPC-MR7WLSUV0N-500-10-10	9	5.5	25	40.9	30.1	7.4	30	19	19	6 x 3.5 x 3.5	M3 x 3	1.9	3.2	14	5.2	500	10	10	1.57	3.14	22.65	14.9	14.9	0.06	0.57
CPC-MR7WLSUV0N-780-15-15	9	5.5	25	40.9	30.1	7.4	30	19	19	6 x 3.5 x 3.5	M3 x 3	1.9	3.2	14	5.2	780	15	15	1.57	3.14	22.65	14.9	14.9	0.06	0.89
CPC-MR7WLSUV0N-1000L	9	5.5	25	40.9	30.1	7.4	30	19	19	6 x 3.5 x 3.5	M3 x 3	1.9	3.2	14	5.2	1000	7.5	7.5	1.57	3.14	22.65	14.9	14.9	0.06	1.14
CPC-MR7WNSUV0N-040-5-5	9	5.5	25	32	21.2	7.3	30	10	19	6 x 3.5 x 3.5	M3 x 3	1.9	3.2	14	5.2	40	5	5	1.18	2.095	15	7.3	7.3	0.04	0.05
CPC-MR7WNSUV0N-080-10-10	9	5.5	25	32	21.2	7.3	30	10	19	6 x 3.5 x 3.5	M3 x 3	1.9	3.2	14	5.2	80	5	5	1.18	2.095	15	7.3	7.3	0.04	0.10
CPC-MR7WNSUV0N-100-5-5	9	5.5	25	32	21.2	7.3	30	10	19	6 x 3.5 x 3.5	M3 x 3	1.9	3.2	14	5.2	100	5	5	1.18	2.095	15	7.3	7.3	0.04	0.11
CPC-MR7WNSUV0N-115-12.5-12.5	9	5.5	25	32	21.2	7.3	30	10	19	6 x 3.5 x 3.5	M3 x 3	1.9	3.2	14	5.2	115	5	5	1.18	2.095	15	7.3	7.3	0.04	0.14
CPC-MR7WNSUV0N-300-15-15	9	5.5	25	32	21.2	7.3	30	10	19	6 x 3.5 x 3.5	M3 x 3	1.9	3.2	14	5.2	300	15	15	1.18	2.095	15	7.3	7.3	0.04	0.34
CPC-MR7WNSUV0N-500-10-10	9	5.5	25	32	21.2	7.3	30	10	19	6 x 3.5 x 3.5	M3 x 3	1.9	3.2	14	5.2	500	10	10	1.18	2.095	15	7.3	7.3	0.04	0.57
CPC-MR7WNSUV0N-780-15-15	9	5.5	25	32	21.2	7.3	30	10	19	6 x 3.5 x 3.5	M3 x 3	1.9	3.2	14	5.2	780	15	15	1.18	2.095	15	7.3	7.3	0.04	0.89
CPC-MR7WNSUV0N-1000L	9	5.5	25	32	21.2	7.3	30	10	19	6 x 3.5 x 3.5	M3 x 3	1.9	3.2	14	5.2	1000	7.5	7.5	1.18	2.095	15	7.3	7.3	0.04	1.14

The rated load capacities and static moment values are calculated according to the ISO14728 standard. The rated life for basic dynamic load is defined as the total 100km travel distance that 90% of a group of identical linear guides can be operated individually under the same conditions, free from any material damage caused by rolling fatigue-When the standard of 50km travel distance is applied. The basic dynamic load rating C of ISO14728 should be multiplied by 1.26 for conversion.

Distributed by Anaheim Automation, Inc.
 USA Stock in Anaheim, CA
 1-800-345-9401
 www.anaheimautomation.com